



### Features

- On/Off output
- Electrical Rating 250Vac
- Switching pressure to be adjusted easy on a scaled adjustment knob
- Static, over, underpressure and vacuum
- IP54 protection

Can be delivered in 3 different alternatives

1. Only the pressure switch
2. The pressure switch separately packed and the duct fixing kit separately packed
3. The pressure switch and the duct fixing kit packed together in one small carton

### Ordering

Type no.	Adjustment range	Switching differential
----------	------------------	------------------------

#### Air differential pressure switch

LF32-02	20-200Pa	10Pa
LF32-03	30-300Pa	10Pa
LF32-04	40-400Pa	20Pa
LF32-05	50-500Pa	20Pa
LF32-10	200-1000Pa	100Pa
LF32-11	100-1000Pa	50Pa
LF32-25	500-2500Pa	150Pa
LF32-50	1000-5000Pa	250Pa

#### Air differential pressure switch with duct fixing kit (DFK 200), packed together into a carton

LF32-02A	20-200Pa	10Pa
LF32-03A	30-300Pa	10Pa
LF32-04A	40-400Pa	20Pa
LF32-05A	50-500Pa	20Pa
LF32-10A	200-1000Pa	100Pa
LF32-11A	100-1000Pa	50Pa
LF32-25A	500-2500Pa	150Pa
LF32-50A	1000-5000Pa	250Pa

DFK 200      Duct fixing kit

### Technical Data

<b>Output</b>	on/off
<b>Max. Operating Pressure</b>	5kPa
<b>Medium</b>	Air, non-combustible and no-aggressive gases
<b>Operating temp. range</b>	-40 C to 85 C
<b>Pressure connections</b>	2 plastic pipe connection pieces(P1 and P2), external diameter 6.0mm; P1 for connection to higher pressure (marked +) P2 for connection to lower pressure(marked -)
<b>Mounting position</b>	Diaphragm in any vertical plane
<b>Contact arrangement</b>	SPDT
<b>Tolerance</b>	15%
<b>Weight</b>	140g
<b>Electrical rating</b>	
- Resistance	initial<400milliohms
- Current	1.5A (0.4A) /250 V
<b>Protection</b>	IP54
<b>Approvals</b>	CE

## Dimensions (mm)

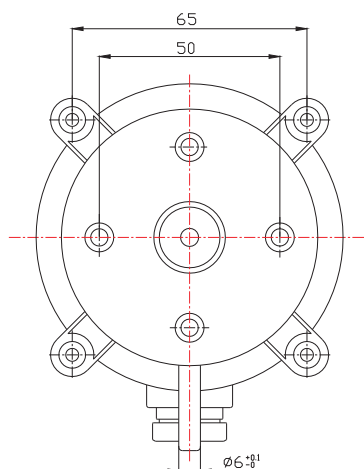
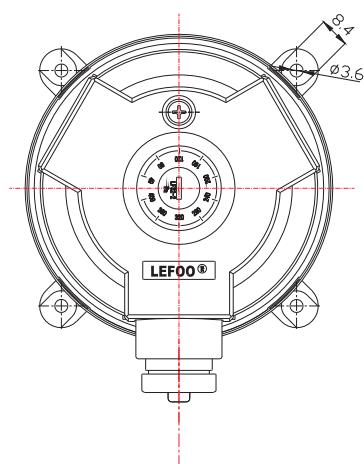
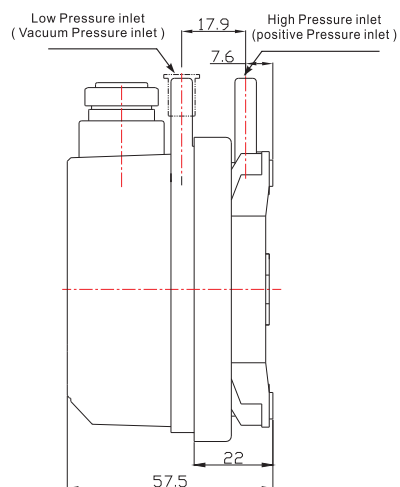

## Options / Accessories

### Duct fixing kit



The DFK 200 duct fixing kit includes:  
2 Plastic tubes with integrated mounting plate  
2 meter PVC hose and 4 screws

### DPST Screw terminal



## Electrical connection

